

BSP NIPLES - DIN PROFILE

NIPLES DI GIUNZIONE BSP - PROFILO DIN

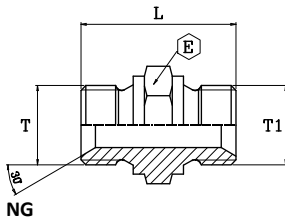

part nr. codice	thread T	thread T1	L		E		Press. Max	
			[in]	[mm]	[in]	[mm]	[psi]	[bar]
*1501010100	1/8-28	1/8-28	0,99	25,0	0,55	14	6164	425
1501013130	1/4-19	1/4-19	1,26	32,0	0,75	19	6164	425
1501017170	3/8-19	3/8-19	1,38	35,0	0,87	22	5801	400
1501021210	1/2-14	1/2-14	1,58	40,0	1,06	27	5076	350
*1501023230	5/8-14	5/8-14	1,65	42,0	1,18	30	4351	300
1501027270	3/4-14	3/4-14	1,79	45,5	1,26	32	3626	250
1501033330	1-11	1-11	2,07	52,5	1,62	41	3626	250
1501042420	1.1/4-11	1.1/4-11	2,27	57,5	1,97	50	2901	200
1501048480	1.1/2-11	1.1/2-11	2,36	60,0	2,17	55	2538	175
1501051510	2-11	2-11	2,80	71,0	2,76	70	2175	150
*1501063630	2.1/2-11	2.1/2-11	2,56	65,0	2,95	75	2175	150
*1501076760	3-11	3-11	2,56	65,0	3,94	100	1450	100

* CR PROFILE / PROFILO CR

BSP REDUCING NIPLES - DIN PROFILE

NIPLES DI RIDUZIONE BSP - PROFILO DIN

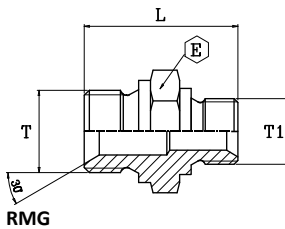

part nr. codice	thread T	thread T1	L		E		Press. Max	
			[in]	[mm]	[in]	[mm]	[psi]	[bar]
*1512013100	1/4-19	1/8-28	1,08	27,5	0,75	19	5076	350
*1512017100	3/8-19	1/8-28	1,16	29,5	0,87	22	5076	350
1512017130	3/8-19	1/4-19	1,26	32,0	0,87	22	5076	350
1512021130	1/2-14	1/4-19	1,36	34,5	1,06	27	5076	350
1512021170	1/2-14	3/8-19	1,40	35,5	1,06	27	5076	350
*1512023210	5/8-14	1/2-14	1,58	40,0	1,18	30	4351	300
*1512027130	3/4-14	1/4-19	1,50	38,0	1,26	32	3626	250
1512027170	3/4-14	3/8-19	1,50	38,0	1,26	32	3626	250
1512027210	3/4-14	1/2-14	1,58	40,0	1,26	32	3626	250
*1512027230	3/4-14	5/8-14	1,69	43,0	1,26	32	3626	250
*1512033170	1-11	3/8-19	1,75	44,5	1,62	41	2901	200
1512033210	1-11	1/2-14	1,85	47,0	1,62	41	2901	200
1512033270	1-11	3/4-14	1,93	49,0	1,62	41	2901	200
1512042210	1.1/4-11	1/2-14	2,01	51,0	1,97	50	2901	200
1512042270	1.1/4-11	3/4-14	2,09	53,0	1,97	50	2901	200
1512042330	1.1/4-11	1-11	2,17	55,0	1,97	50	2901	200
1512048270	1.1/2-11	3/4-14	2,13	54,0	2,17	55	2538	175
1512048330	1.1/2-11	1-11	2,21	56,0	2,17	55	2538	175
1512048420	1.1/2-11	1.1/4-11	2,29	58,0	2,17	55	2538	175
1512051420	2-11	1.1/4-11	2,58	65,5	2,76	70	2175	150
1512051480	2-11	1.1/2-11	2,66	67,5	2,76	70	2175	150

* CR PROFILE / PROFILO CR

BSP/METRIC NIPLES

NIPLES BSP/METRICO

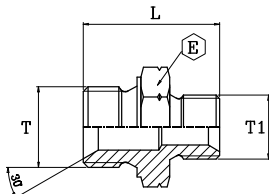

RMGM

part nr. codice	thread T	thread T1	L		E		Press. Max	
			[in]	[mm]	[in]	[mm]	[psi]	[bar]
1512113100	1/4-19	M10-1	1,10	28,0	0,75	19	6164	425
1512113120	1/4-19	M12-1,5	1,14	29,0	0,75	19	6164	425
1512113140	1/4-19	M14-1,5	1,18	30,0	0,75	19	6164	425
1512113160	1/4-19	M16-1,5	1,30	33,0	0,87	22	4351	300
1512113180	1/4-19	M18-1,5	1,30	33,0	0,95	24	4351	300
1512117140	3/8-19	M14-1,5	1,30	33,0	0,87	22	4351	300
1512117160	3/8-19	M16-1,5	1,38	35,0	0,87	22	4351	300
1512117180	3/8-19	M18-1,5	1,38	35,0	0,95	24	4351	300
1512117220	3/8-19	M22-1,5	1,44	36,5	1,06	27	3626	250
1512121140	1/2-14	M14-1,5	1,40	35,5	1,06	27	3626	250
1512121160	1/2-14	M16-1,5	1,48	37,5	1,06	27	3626	250
1512121180	1/2-14	M18-1,5	1,44	36,5	1,06	27	3626	250
1512121220	1/2-14	M22-1,5	1,50	38,0	1,06	27	3626	250
1512127180	3/4-14	M18-1,5	1,65	42,0	1,26	32	2901	200
1512127220	3/4-14	M22-1,5	1,65	42,0	1,26	32	2901	200
1512127260	3/4-14	M26-1,5	1,69	43,0	1,26	32	2901	200
1512133260	1-11	M26-1,5	1,67	42,5	1,62	41	2901	200

METRIC NIPLES

NIPLES DI GIUNZIONE METRICO

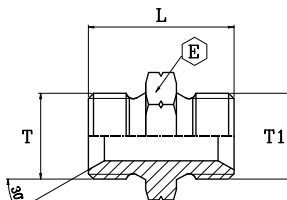

NM

part nr. codice	thread T	thread T1	L		E		Press. Max	
			[in]	[mm]	[in]	[mm]	[psi]	[bar]
1501110100	M10-1	M10-1	0,99	25,0	0,55	14	6164	425
1501112120	M12-1,5	M12-1,5	1,14	29,0	0,67	17	6164	425
1501114140	M14-1,5	M14-1,5	1,22	31,0	0,75	19	5801	400
1501116160	M16-1,5	M16-1,5	1,38	35,0	0,87	22	5076	350
1501118180	M18-1,5	M18-1,5	1,42	36,0	0,95	24	5076	350
1501120200	M20-1,5	M20-1,5	1,50	38,0	1,06	27	5076	350
1501122220	M22-1,5	M22-1,5	1,50	38,0	1,06	27	5076	350
1501124240	M24-1,5	M24-1,5	1,42	36,0	1,18	30	3626	250
1501126260	M26-1,5	M26-1,5	1,65	42,0	1,26	32	3626	250
1501130300	M30-1,5	M30-1,5	1,62	41,0	1,50	38	2901	200

METRIC REDUCING NIPLES

NIPLES DI RIDUZIONE METRICO

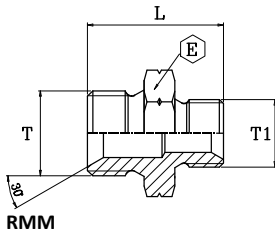

part nr. codice	thread T	thread T1	L		E		Press. Max	
			[in]	[mm]	[in]	[mm]	[psi]	[bar]
1512314100	M14-1,5	M10-1	1,12	28,5	0,75	19	5076	350
1512314120	M14-1,5	M12-1,5	1,18	30,0	0,75	19	5076	350
1512316120	M16-1,5	M12-1,5	1,22	31,0	0,87	22	5076	350
1512316140	M16-1,5	M14-1,5	1,22	31,0	0,87	22	5076	350
1512318140	M18-1,5	M14-1,5	1,34	34,0	0,95	24	5076	350
1512318160	M18-1,5	M16-1,5	1,42	36,0	0,95	24	5076	350
1512322160	M22-1,5	M16-1,5	1,46	37,0	1,06	27	5076	350
1512322180	M22-1,5	M18-1,5	1,48	37,5	1,06	27	3626	250
1512326220	M26-1,5	M22-1,5	1,50	38,0	1,26	32	2901	200

BSP / BSPT NIPLES

BSP / BSPT NIPLES

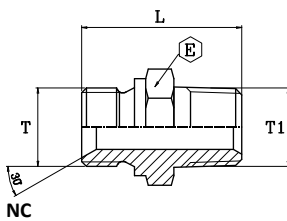

part nr. codice	thread T	thread T1	L		E		Press. Max	
			[in]	[mm]	[in]	[mm]	[psi]	[bar]
1501610100	1/8-28	1/8-28	1,04	26,5	0,47	12	6164	425
1501613130	1/4-19	1/4-19	1,26	32,0	0,67	17	6164	425
1501617170	3/8-19	3/8-19	1,38	35,0	0,75	19	5801	400
1501617171	3/8-19	3/8-19	1,40	35,5	0,87	22	5801	400
1501621210	1/2-14	1/2-14	1,67	42,5	0,95	24	4351	300
1501627270	3/4-14	3/4-14	1,81	46,0	1,26	32	3626	250
1501633330	1-11	1-11	2,17	55,0	1,42	36	3626	250
1501642420	1.1/4-11	1.1/4-11	2,36	60,0	1,97	50	2901	200
1501648480	1.1/2-11	1.1/2-11	2,42	61,5	1,97	50	2538	175
1501651510	2-11	2-11	2,68	68,0	2,56	65	2175	150

BSP / NPTF NIPLES

NIPLES BSP / NPTF

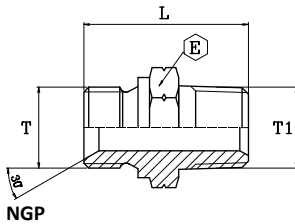

NGP

part nr. codice	thread T	thread T1	L		E		Press. Max	
			[in]	[mm]	[in]	[mm]	[psi]	[bar]
1501710100	1/8-28	1/8-28	1,08	27,5	0,47	12	6164	425
1501713130	1/4-19	1/4-19	1,26	32,0	0,59	15	6164	425
1501717170	3/8-19	3/8-19	1,28	32,5	0,67	17	5801	400
1501721210	1/2-14	1/2-14	1,67	42,5	0,95	24	4351	300
1501721211	1/2-14	1/2-14	1,73	44,0	1,06	27	4351	300
1501727270	3/4-14	3/4-14	1,77	45,0	1,06	27	3626	250
1501733330	1-11	1-11	2,17	55,0	1,42	36	2901	200
1501742420	1.1/4-11	1.1/4-11	2,29	58,0	1,77	45	2901	200
1501748480	1.1/2-11	1.1/2-11	2,38	60,5	1,97	50	2538	175
1501751510	2-11	2-11	2,69	68,2	2,56	65	2175	150

BSP MALE - SWIVEL FEMALE 60° FLARE
ADATTATORE BSP M/F GIREVOLE SV.60°
15060

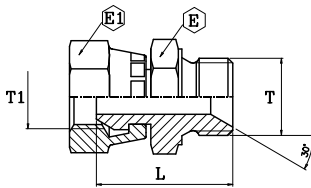

NMG

BSP MALE - SWIVEL FEMALE 60° FLARE WITH THRUST WIRE NUT
ADATTATORE BSP M/F GIREVOLE SV.60° CON DADO SPINATO
15065

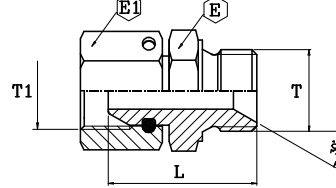

part nr. codice	thread T	thread T1	L		E		E1		Press. Max	
			[in]	[mm]	[in]	[mm]	[in]	[mm]	[psi]	[bar]
1506010100	1/8-28	1/8-28	0,95	24,0	0,55	14	0,55	14	6164	425
1506013130	1/4-19	1/4-19	1,14	29,0	0,75	19	0,75	19	6164	425
1506017170	3/8-19	3/8-19	1,32	33,5	0,87	22	0,87	22	5801	400
1506021210	1/2-14	1/2-14	1,54	39,0	1,06	27	1,06	27	5076	350
1506027270	3/4-14	3/4-14	1,73	44,0	1,26	32	1,26	32	3626	250
1506033330	1-11	1-11	1,79	45,5	1,62	41	1,50	38	3626	250
1506542420	1.1/4-11	1.1/4-11	2,13	54,0	1,97	50	1,97	50	2901	200
1506548480	1.1/2-11	1.1/2-11	2,32	59,0	2,17	55	1,97	50	2538	175
1506551510	2-11	2-11	2,36	60,0	2,76	70	2,56	65	2175	150

BSP SWIVEL FEMALE / FEMALE 60° FLARE
ADATTATORE BSP F/F GIREVOLE SV.60°

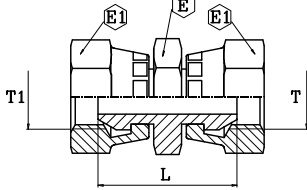

NFG

BSP SWIVEL F/F 60° FLARE WITH THRUST WIRE NUT
ADATTATORE BSP F/F GIREVOLE SV.60° CON DADO SPINATO

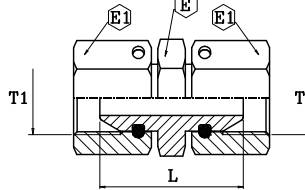

part nr. codice	thread T	thread T1	L		E		E1		Press. Max	
	[in]	[mm]	[in]	[mm]	[in]	[mm]	[in]	[mm]	[psi]	[bar]
1507010100	1/8-28	1/8-28	0,99	25,0	0,55	14	0,55	14	6164	425
1507013130	1/4-19	1/4-19	1,08	27,5	0,75	19	0,75	19	6164	425
1507017170	3/8-19	3/8-19	1,30	33,0	0,87	22	0,87	22	5801	400
1507021210	1/2-14	1/2-14	1,46	37,0	1,06	27	1,06	27	5076	350
1507027270	3/4-14	3/4-14	1,71	43,5	1,26	32	1,26	32	3626	250
1507033330	1-11	1-11	1,67	42,5	1,62	41	1,50	38	3626	250
1507042420	1.1/4-11	1.1/4-11	2,17	55,0	1,97	50	1,97	50,0	2901	200
1507048480	1.1/2-11	1.1/2-11	2,40	61,0	2,17	55	2,17	55,0	2538	175
1507051510	2-11	2-11	2,25	57,0	2,56	65	2,76	70,0	2175	150
1507042420	1.1/4-11	1.1/4-11	2,17	55,0	1,97	50	1,97	50,0	2901	200
1507048480	1.1/2-11	1.1/2-11	2,40	61,0	2,17	55	2,17	55,0	2538	175
1507051510	2-11	2-11	2,25	57,0	2,56	65	2,76	70,0	2175	150

BSP BULKHEAD NIPLES WITH LOCKNUT **NIPLES PASSAPARETE BSP**

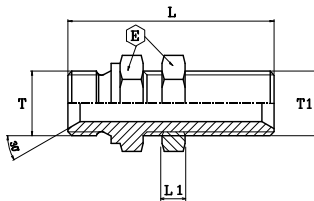

NPPG

part nr. codice	thread T	thread T1	L		L1		E		Press. Max	
	[in]	[mm]	[in]	[mm]	[in]	[mm]	[in]	[mm]	[psi]	[bar]
1508013130	1/4-19	1/4-19	1,77	45,0	0,28	7,0	0,75	19	6164	425
1508017170	3/8-19	3/8-19	2,13	54,0	0,32	8,0	0,87	22	5801	400
1508021210	1/2-14	1/2-14	2,30	58,5	0,35	9,0	1,06	27	4351	300
1508027270	3/4-14	3/4-14	2,56	65,0	0,39	10,0	1,26	32	3626	250
1508033330	1-11	1-11	2,92	74,0	0,43	11,0	1,62	41	2901	200
1508042420	1.1/4-11	1.1/4-11	3,11	79,0	0,51	13,0	1,97	50	2901	200

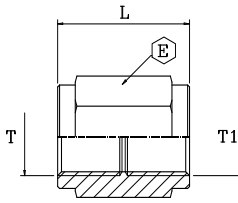
BSP FIXED F/F
PROLUNGA BSP F/F

PFFG

part nr. codice	thread T	thread T1	L		E		Press. Max	
			[in]	[mm]	[in]	[mm]	[psi]	[bar]
1511010100	1/8-28	1/8-28	1,18	30,0	0,55	14	3626	250
1511013130	1/4-19	1/4-19	1,38	35,0	0,75	19	4351	300
1511017170	3/8-19	3/8-19	1,58	40,0	0,87	22	4351	300
1511021210	1/2-14	1/2-14	1,34	34,0	1,06	27	3626	250
1511027270	3/4-14	3/4-14	1,97	50,0	1,26	32	2901	200
1511033330	1-11	1-11	1,69	43,0	1,62	41	2901	200
1511042420	1.1/4-11	1.1/4-11	1,85	47,0	1,97	50	2175	150
1511048480	1.1/2-11	1.1/2-11	2,76	70,0	2,17	55	2175	150
1511051510	2-11	2-11	2,25	57,0	2,76	70	2175	150