

FLANGE SAE 3000 TYPE SUPER SPIRAL

FLANGIA SAE 3000 TIPO SUPER SPIRAL

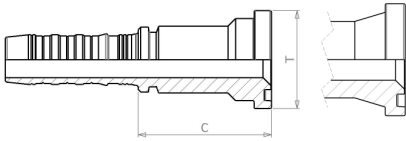

SFL-3-SSP

part nr. codice	hose ID			T			cut-off C	
	[in]	[mm]	size	[in]	[mm]	size	[in]	[mm]
HS54060821	1/2	12,7	08	1,19	30,2	1/2	1,91	48,5
HS54061227	3/4	19,0	12	1,50	38,1	3/4	2,05	52
HS54061233	3/4	19,0	12	1,75	44,5	1	2,21	56
HS54061633	1	25,4	16	1,75	44,5	1	2,27	57,5
HS54061642	1	25,4	16	2,00	50,8	1.1/4	2,40	61
HS54062042	1.14	31,8	20	2,00	50,8	1.1/4	2,44	62
HS54062448	1.1/2	38,1	24	2,38	60,4	1.1/2	2,56	65
HS54063251	2	50,8	32	2,81	71,4	2	2,80	71

FLANGE SAE 3000 90° ELBOW TYPE
SUPER SPIRAL

FLANGIA 90° SAE 3000 TIPO SUPER
SPIRAL

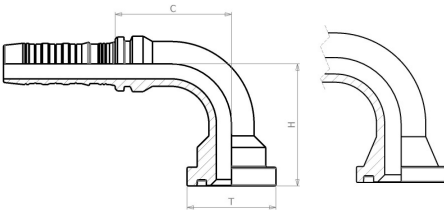

SFL-3-90-SSP

part nr. codice	hose ID			T			cut-off C		drop H	
	[in]	[mm]	size	[in]	[mm]	size	[in]	[mm]	[in]	[mm]
HS55060821	1/2	12,7	08	1,19	30,2	1/2	1,65	42	1,54	39
HS55061227	3/4	19,0	12	1,50	38,1	3/4	2,15	54,5	2,17	55
HS55061233	3/4	19,0	12	1,75	44,5	1	2,32	59	2,29	58
HS55061633	1	25,4	16	1,75	44,5	1	2,88	73	2,60	66
HS55061642	1	25,4	16	2,00	50,8	1.1/4	2,99	76	2,96	75
HS55062042	1.14	31,8	20	2,00	50,8	1.1/4	3,74	95	3,07	78
HS55062448	1.1/2	38,1	24	2,38	60,4	1.1/2	4,41	112	3,55	90
HS55063251	2	50,8	32	2,81	71,4	2	5,24	133	4,33	110

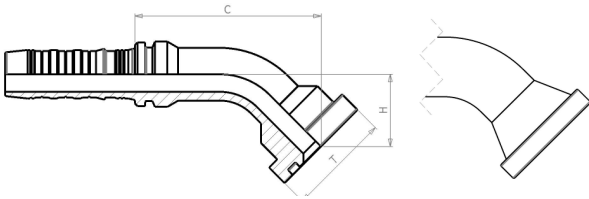
**FLANGE SAE 3000 45° ELBOW TYPE
SUPER SPIRAL**
**FLANGIA 45° SAE 3000 TIPO SUPER
SPIRAL**

SFL-3-45-SSP

part nr. codice	hose ID			T			cut-off C		drop H	
	[in]	[mm]	size	[in]	[mm]	size	[in]	[mm]	[in]	[mm]
HS57060821	1/2	12,7	08	1,19	30,2	1/2	2,13	54	0,87	22
HS57061227	3/4	19,0	12	1,50	38,1	3/4	2,86	72,5	1,18	30
HS57061233	3/4	19,0	12	1,75	44,5	1	2,99	76	1,22	31
HS57061633	1	25,4	16	1,75	44,5	1	3,55	90	1,38	35
HS57061642	1	25,4	16	2,00	50,8	1.1/4	3,70	94	1,54	39
HS57062042	1.14	31,8	20	2,00	50,8	1.1/4	4,10	104	1,81	46
HS57062448	1.1/2	38,1	24	2,38	60,4	1.1/2	4,57	116	2,01	51
HS57063251	2	50,8	32	2,81	71,4	2	5,28	134	2,21	56