

BSP PARALLEL MALE 60° FLARE

MASCHIO BSP CILINDRICO SV.60°

AGR

part nr. codice	hose ID		size	thread T	d		E		cutt-off C	
	[in]	[mm]			[in]	[mm]	[in]	[mm]	[in]	[mm]
0402000310	3/16"	4,8	03	1/8-28	0,12	3,0	0,55	14	0,83	21,0
0402000313	3/16"	4,8	03	1/4-19	0,12	3,0	0,75	19	1,02	26,0
0402000410	1/4"	6,4	04	1/8-28	0,16	4,0	0,55	14	0,83	21,0
0402000413	1/4"	6,4	04	1/4-19	0,16	4,0	0,75	19	1,06	27,0
0402000417	1/4"	6,4	04	3/8-19	0,16	4,0	0,87	22	1,10	28,0
0402000421	1/4"	6,4	04	1/2-14	0,16	4,0	1,06	27	1,26	32,0
0402000513	5/16"	8,0	05	1/4-19	0,22	5,5	0,75	19	1,06	27,0
0402000517	5/16"	8,0	05	3/8-19	0,22	5,5	0,87	22	1,10	28,0
0402000521	5/16"	8,0	05	1/2-14	0,22	5,5	1,06	27	1,26	32,0
0402000613	3/8"	9,5	06	1/4-19	0,28	7,0	0,75	19	1,06	27,0
0402000617	3/8"	9,5	06	3/8-19	0,28	7,0	0,87	22	1,14	29,0
0402000621	3/8"	9,5	06	1/2-14	0,28	7,0	1,06	27	1,26	32,0
0402000817	1/2"	12,7	08	3/8-19	0,37	9,5	0,87	22	1,14	29,0
0402000821	1/2"	12,7	08	1/2-14	0,37	9,5	1,06	27	1,30	33,0
0402000823	1/2"	12,7	08	5/8-14	0,37	9,5	1,18	30	1,34	34,0
0402000827	1/2"	12,7	08	3/4-14	0,37	9,5	1,26	32	1,38	35,0
0402001021	5/8"	16,0	10	1/2-14	0,47	12,0	1,06	27	1,30	33,0
0402001023	5/8"	16,0	10	5/8-14	0,47	12,0	1,18	30	1,34	34,0
0402001027	5/8"	16,0	10	3/4-14	0,47	12,0	1,26	32	1,38	35,0
0402001221	3/4"	19,0	12	1/2-14	0,59	15,0	1,06	27	1,34	34,0
0402001227	3/4"	19,0	12	3/4-14	0,59	15,0	1,26	32	1,42	36,0
0402001233	3/4"	19,0	12	1-11	0,59	15,0	1,62	41	1,54	39,0
0402001633	1"	25,4	16	1-11	0,79	20,0	1,62	41	1,58	40,0
0402001642	1"	25,4	16	1.1/4-11	0,79	20,0	1,97	50	1,73	44,0
0402002042	1.1/4"	31,8	20	1.1/4-11	1,02	26,0	1,97	50	1,77	45,0
0402002048	1.1/4"	31,8	20	1.1/2-11	1,02	26,0	2,17	55	1,81	46,0
0402002448	1.1/2"	38,1	24	1.1/2-11	1,26	32,0	2,17	55	1,81	46,0
0402002451	1.1/2"	38,1	24	2-11	1,26	32,0	2,76	70	2,11	53,5
0402003251	2"	50,8	32	2-11	1,73	44,0	2,76	70	2,11	53,5
0402004063	2.1/2"	63,0	40	2.1/2-11	2,17	55,0	3,35	85	2,05	52,0
0402004876	3"	76,0	48	3-11	2,68	68,0	3,94	100	2,05	52,0

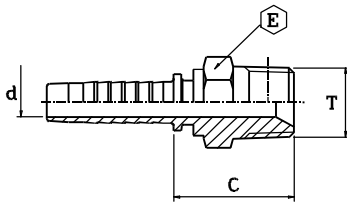

BSP TAPERED MALE 60° FLARE

MASCHIO BSP CONICO SV.60°

AGR-K

part nr. codice	hose ID			thread T	d		E		cut-off C	
	[in]	[mm]	size		[in]	[mm]	[in]	[mm]	[in]	[mm]
0402010310	3/16"	4,8	03	1/8-28	0,12	3,0	0,47	12	0,87	22,0
0402010313	3/16"	4,8	03	1/4-19	0,12	3,0	0,59	15	1,06	27,0
0402010410	1/4"	6,4	04	1/8-28	0,16	4,0	0,47	12	0,91	23,0
0402010413	1/4"	6,4	04	1/4-19	0,16	4,0	0,59	15	1,10	28,0
0402010417	1/4"	6,4	04	3/8-19	0,16	4,0	0,75	19	1,10	28,0
0402010513	5/16"	8,0	05	1/4-19	0,22	5,5	0,59	15	1,10	28,0
0402010517	5/16"	8,0	05	3/8-19	0,22	5,5	0,75	19	1,10	28,0
0402010613	3/8"	9,5	06	1/4-19	0,28	7,0	0,59	15	1,10	28,0
0402010617	3/8"	9,5	06	3/8-19	0,28	7,0	0,75	19	1,10	28,0
0402010621	3/8"	9,5	06	1/2-14	0,28	7,0	0,87	22	1,30	33,0
0402010817	1/2"	12,7	08	3/8-19	0,37	9,5	0,75	19	1,14	29,0
0402010821	1/2"	12,7	08	1/2-14	0,37	9,5	0,87	22	1,34	34,0
0402010827	1/2"	12,7	08	3/4-14	0,37	9,5	1,06	27	1,42	36,0
0402011021	5/8"	16,0	10	1/2-14	0,47	12,0	0,87	22	1,34	34,0
0402011027	5/8"	16,0	10	3/4-14	0,47	12,0	1,06	27	1,42	36,0
0402011227	3/4"	19,0	12	3/4-14	0,59	15,0	1,06	27	1,46	37,0
0402011233	3/4"	19,0	12	1-11	0,59	15,0	1,42	36	1,69	43,0
0402011633	1"	25,4	16	1-11	0,79	20,0	1,42	36	1,73	44,0
0402011642	1"	25,4	16	1.1/4-11	0,79	20,0	1,81	46	1,81	46,0
0402012042	1.1/4"	31,8	20	1.1/4-11	1,02	26,0	1,81	46	1,85	47,0
0402012048	1.1/4"	31,8	20	1.1/2-11	1,02	26,0	1,97	50	1,93	49,0
0402012448	1.1/2"	38,1	24	1.1/2-11	1,26	32,0	1,97	50	1,93	49,0
0402012451	1.1/2"	38,1	24	2-11	1,26	32,0	2,56	65	2,17	55,0
0402013251	2"	50,8	32	2-11	1,73	44,0	2,56	65	2,17	55,0

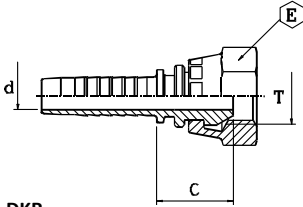
**BSP FEMALE 60° FLARE
 FEMMINA BSP SV.60°
 041620**

DKR

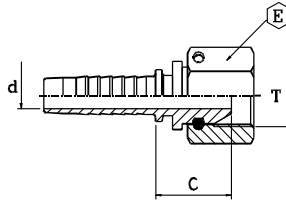
**BSP FEMALE 60° FLARE WITH O'RING
 FEMMINA BSP SV.60° CON O'RING
 041640**

part nr. codice	hose ID		size	thread	d		E		cut-off C	
	[in]	[mm]		T	[in]	[mm]	[in]	[mm]	[in]	[mm]
0416200310	3/16"	4,8	03	1/8-28	0,12	3,0	0,55	14	0,63	16,0
0416200313	3/16"	4,8	03	1/4-19	0,12	3,0	0,75	19	0,71	18,0
0416200317	3/16"	4,8	03	3/8-19	0,12	3,0	0,87	22	0,79	20,0
0416200410	1/4"	6,4	04	1/8-28	0,16	4,0	0,55	14	0,63	16,0
0416200413	1/4"	6,4	04	1/4-19	0,16	4,0	0,75	19	0,71	18,0
0416200417	1/4"	6,4	04	3/8-19	0,16	4,0	0,87	22	0,79	20,0
0416200421	1/4"	6,4	04	1/2-14	0,16	4,0	1,06	27	0,87	22,0
0416200513	5/16"	8,0	05	1/4-19	0,22	5,5	0,75	19	0,71	18,0
0416200517	5/16"	8,0	05	3/8-19	0,22	5,5	0,87	22	0,79	20,0
0416200521	5/16"	8,0	05	1/2-14	0,22	5,5	1,06	27	0,87	22,0
0416200613	3/8"	9,5	06	1/4-19	0,28	7,0	0,75	19	0,71	18,0
0416200617	3/8"	9,5	06	3/8-19	0,28	7,0	0,87	22	0,79	20,0
0416200621	3/8"	9,5	06	1/2-14	0,28	7,0	1,06	27	0,87	22,0
0416200817	1/2"	12,7	08	3/8-19	0,35	9,0	0,87	22	0,79	20,0
0416200821	1/2"	12,7	08	1/2-14	0,37	9,5	1,06	27	0,91	23,0
0416200823	1/2"	12,7	08	5/8-14	0,37	9,5	1,18	30	0,91	23,0
0416200827	1/2"	12,7	08	3/4-14	0,37	9,5	1,26	32	0,87	22,0
0416201021	5/8"	16,0	10	1/2-14	0,47	12,0	1,06	27	0,91	23,0
0416201023	5/8"	16,0	10	5/8-14	0,47	12,0	1,18	30	0,87	22,0
0416201027	5/8"	16,0	10	3/4-14	0,47	12,0	1,26	32	0,87	22,0
0416201227	3/4"	19,0	12	3/4-14	0,59	15,0	1,26	32	0,91	23,0
0416201233	3/4"	19,0	12	1-11	0,59	15,0	1,50	38	0,99	25,0
0416201633	1"	25,4	16	1-11	0,79	20,0	1,50	38	1,02	26,0
*0416401642	1"	25,4	16	1.1/4-11	0,79	20,0	1,97	50	1,18	30,0
*0416402042	1.1/4"	31,8	20	1.1/4-11	1,02	26,0	1,97	50	1,26	32,0
*0416402048	1.1/4"	31,8	20	1.1/2-11	1,02	26,0	2,17	55	1,34	34,0
*0416402448	1.1/2"	38,1	24	1.1/2-11	1,26	32,0	2,17	55	1,34	34,0
*0416402451	1.1/2"	38,1	24	2-11	1,26	32,0	2,76	70	1,22	31,0
*0416403251	2"	50,8	32	2-11	1,73	44,0	2,76	70	1,22	31,0
0416404063	2.1/2"	63,0	40	2.1/2-11	2,17	55,0	3,35	85	1,42	36,0
0416404876	3"	76,0	48	3-11	2,68	68,0	3,94	100	1,58	40,0

* WITH O'RING IN THE CONE / CON O'RING NEL CONO

BSP FEMALE 60° FLARE 90° ELBOW
FEMMINA 90° BSP SV.60°
042720

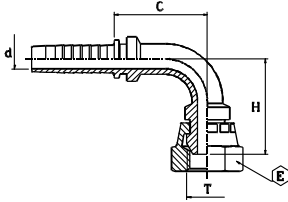

DKR-90

BSP FEMALE 60° FLARE 90° ELBOW WITH THRUST WIRE NUT
FEMMINA 90° BSP SV.60° CON DADO SPINATO
042740 / 042744

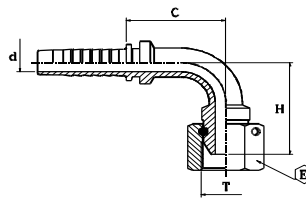

part nr. codice	hose ID		size	thread T	d		E		cut-off C		drop H	
	[in]	[mm]			[in]	[mm]	[in]	[mm]	[in]	[mm]	[in]	[mm]
0427200310	3/16"	4,8	03	1/8-28	0,12	3,0	0,55	14	0,87	22,0	0,95	24,0
0427200313	3/16"	4,8	03	1/4-19	0,12	3,0	0,75	19	0,91	23,0	1,10	28,0
0427200413	1/4"	6,4	04	1/4-19	0,16	4,0	0,75	19	0,99	25,0	1,10	28,0
0427200417	1/4"	6,4	04	3/8-19	0,16	4,0	0,87	22	0,99	25,0	1,22	31,0
0427200517	5/16"	8,0	05	3/8-19	0,22	5,5	0,87	22	1,14	29,0	1,42	36,0
0427200617	3/8"	9,5	06	3/8-19	0,28	7,0	0,87	22	1,30	33,0	1,38	35,0
0427200621	3/8"	9,5	06	1/2-14	0,28	7,0	1,06	27	1,30	33,0	1,46	37,0
0427200817	1/2"	12,7	08	3/8-19	0,37	9,5	0,87	22	1,54	39,0	1,62	41,0
0427200821	1/2"	12,7	08	1/2-14	0,37	9,5	1,06	27	1,54	39,0	1,62	41,0
0427200823	1/2"	12,7	08	5/8-14	0,37	9,5	1,18	30	1,54	39,0	1,73	44,0
0427200827	1/2"	12,7	08	3/4-14	0,37	9,5	1,26	32	1,54	39,0	1,73	44,0
0427201023	5/8"	16,0	10	5/8-14	0,47	12,0	1,18	30	1,77	45,0	1,93	49,0
0427201027	5/8"	16,0	10	3/4-14	0,47	12,0	1,26	32	1,77	45,0	2,01	51,0
0427201227	3/4"	19,0	12	3/4-14	0,59	15,0	1,26	32	2,21	56,0	2,13	54,0
0427201233	3/4"	19,0	12	1-11	0,59	15,0	1,50	38	2,21	56,0	2,29	58,0
0427201633	1"	25,4	16	1-11	0,79	20,0	1,50	38	2,76	70,0	2,56	65,0
*0427402042	1.1/4"	31,8	20	1.1/4-11	1,02	26,0	1,97	50	3,35	85,0	3,39	86,0
*0427402448	1.1/2"	38,1	24	1.1/2-11	1,18	30,0	2,17	55	3,90	99,0	3,94	100,0
*0427403251	2"	50,8	32	2-11	1,57	40,0	2,76	70	5,03	128,0	5,00	127,0
**0427444063	2.1/2"	63,0	40	2.1/2-11	2,17	55,0	3,35	85	3,70	94,0	4,06	103,0
**0427444876	3"	76,0	48	3-11	2,68	68,0	3,94	100	4,61	117,0	5,04	128,0

* WITH O'RING IN THE CONE / CON O'RING NEL CONO

** WELDED / SALDATO

BSP FEMALE 60° FLARE 45° ELBOW
FEMMINA 45° BSP SV.60°
042820

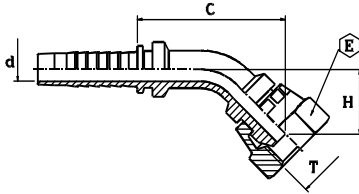

BSP FEMALE 60° FLARE 45° ELBOW WITH THRUST WIRE NUT
FEMMINA 45° BSP SV.60° CON DADO SPINATO
042840 / 042844

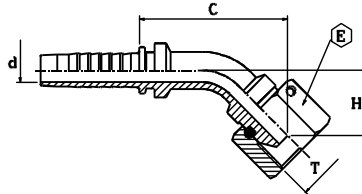

DKR-45

part nr. codice	hose ID			thread T	d		E		cut-off C		drop H	
	[in]	[mm]	size		[in]	[mm]	[in]	[mm]	[in]	[mm]	[in]	[mm]
0428200310	3/16"	4,8	03	1/8-28	0,12	3,0	0,55	14	1,34	34,0	0,63	16,0
0428200313	3/16"	4,8	03	1/4-19	0,12	3,0	0,75	19	1,53	39,0	0,63	16,0
0428200413	1/4"	6,4	04	1/4-19	0,16	4,0	0,75	19	1,38	35,0	0,63	16,0
0428200413L	1/4"	6,4	04	1/4-19	0,16	4,0	0,75	19	1,62	41,0	0,63	16,0
0428200417	1/4"	6,4	04	3/8-19	0,16	4,0	0,87	22	1,69	43,0	0,71	18,0
0428200517	5/16"	8,0	05	3/8-19	0,22	5,5	0,87	22	1,97	50,0	0,75	19,0
0428200617	3/8"	9,5	06	3/8-19	0,28	7,0	0,87	22	2,04	52,0	0,75	19,0
0428200621	3/8"	9,5	06	1/2-14	0,28	7,0	1,06	27	2,08	53,0	0,79	20,0
0428200821	1/2"	12,7	08	1/2-14	0,37	9,5	1,06	27	1,97	50,0	0,91	23,0
0428200823L	1/2"	12,7	08	5/8-14	0,37	9,5	1,18	30	2,56	65,0	0,95	24,0
0428200827	1/2"	12,7	08	3/4-14	0,37	9,5	1,26	32	2,56	65,0	0,91	23,0
0428201023	5/8"	16,0	10	5/8-14	0,47	12,0	1,18	30	2,75	70,0	1,02	26,0
0428201027	5/8"	16,0	10	3/4-14	0,47	12,0	1,26	32	2,75	70,0	1,02	26,0
0428201227	3/4"	19,0	12	3/4-14	0,59	15,0	1,26	32	3,30	84,0	1,06	27,0
0428201233	3/4"	19,0	12	1-11	0,59	15,0	1,50	38	3,42	87,0	1,18	30,0
0428201633	1"	25,4	16	1-11	0,79	20,0	1,50	38	3,30	84,0	1,38	35,0
*0428401642	1"	25,4	16	1.1/4-11	0,79	20,0	1,97	50	3,38	86,0	1,46	37,0
*0428402042	1.1/4"	31,8	20	1.1/4-11	1,02	26,0	1,97	50	4,06	103,0	1,97	50,0
*0428402448	1.1/2"	38,1	24	1.1/2-11	1,18	30,0	2,17	55	4,57	116,0	2,17	55,0
*0428403251	2"	50,8	32	2-11	1,57	40,0	2,76	70	5,63	143,0	2,76	70,0
**0428444063	2.1/2"	63,0	40	2.1/2-11	2,17	55,0	3,35	85	3,94	100,0	1,85	47,0
**0428444876	3"	76,0	48	3-11	2,68	68,0	3,94	100	4,85	123,0	2,25	57,0

* WITH O-RING IN THE CONE / CON O-RING NEL CONO

** WELDED / SALDATO

BSP FEMALE 60° FLARE WITH O'RING
FEMMINA BSP SV.60° CON O'RING
041760

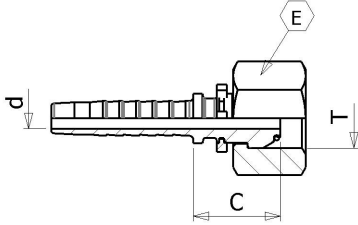

BSP FEMALE 60° FLARE WITH O'RING CRIMPED NUT
FEMMINA BSP SV.60° CON O'RING DADO PINZATO
041660

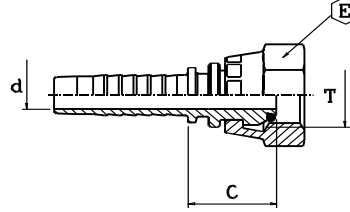

DKR-OR

part nr. codice	hose ID			thread T	d		E		cut-off C	
	[in]	[mm]	size		[in]	[mm]	[in]	[mm]	[in]	[mm]
0417600413	1/4"	6,4	04	1/4-19	0,16	4,0	0,75	19	0,67	17,0
0417600617	3/8"	9,5	06	3/8-19	0,28	7,0	0,87	22	0,79	20,0
0417600821	1/2"	12,7	08	1/2-14	0,37	9,5	1,06	27	0,83	21,0
0416601227	3/4"	19,0	12	3/4-14	0,59	15,0	1,26	32	0,91	23,0
0416601633	1"	25,4	16	1-11	0,79	20,0	1,50	38	1,02	26,0

BSP FEMALE 60° FLARE 90° ELBOW WITH O'RING
FEMMINA 90° BSP SV. 60° CON O-RING
042761

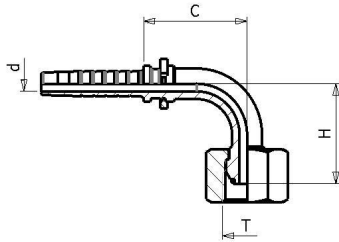

BSP FEMALE 60° FLARE 90° ELBOW WITH O'RING WITH CRIMPED NUT
FEMMINA 90° BSP SV. 60° CON O-RING DADO PINZATO
042760

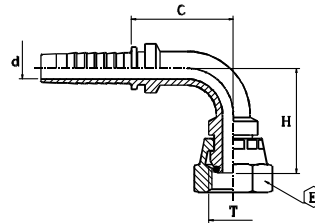

DKR-OR-90

part nr. codice	hose ID			thread T	d		E		cut-off C		drop H	
	[in]	[mm]	size		[in]	[mm]	[in]	[mm]	[in]	[mm]	[in]	[mm]
0427610413	1/4"	6,4	04	1/4-19	0,16	4,0	0,75	19	1,10	28,0	1,02	26,0
0427610617	3/8"	9,5	06	3/8-19	0,28	7,0	0,87	22	1,22	31,0	1,22	31,0
0427610821	1/2"	12,7	08	1/2-14	0,37	9,5	1,06	27	1,62	41,0	1,34	34,0
0427601227	3/4"	19,0	12	3/4-14	0,59	15,0	1,26	32	2,21	56,0	2,13	54,0
0427601633	1"	25,4	16	1-11	0,79	20,0	1,50	38	2,76	70,0	2,60	66,0

BSP FEMALE 60° FLARE 45° ELBOW WITH O’RING
FEMMINA 45° BSP SV.60° CON O’RING
042861

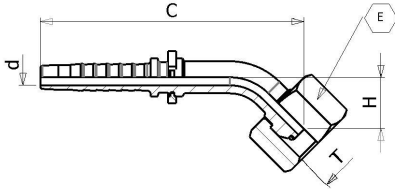

BSP FEMALE 60° FLARE 45° ELBOW WITH O’RING CRIMPED NUT
FEMMINA 45° BSP SV.60° CON O’RING DADO PINZATO
042860

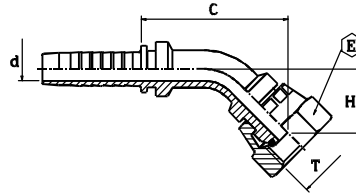

DK-OR-45

part nr. codice	hose ID			thread T	d		E		cut-off C		drop H	
	[in]	[mm]	size		[in]	[mm]	[in]	[mm]	[in]	[mm]	[in]	[mm]
*0428610413	1/4"	6,4	04	1/4-19	0,16	4,0	0,75	19	1,69	40,0	0,51	13,0
*0428610617	3/8"	9,5	06	3/8-19	0,28	7,0	0,87	22	1,97	50,0	0,63	16,0
*0428610821	1/2"	12,7	08	1/2-14	0,37	9,5	1,06	27	2,36	60,0	0,63	16,0
*0428601227	3/4"	19,0	12	3/4-14	0,59	15,0	1,26	32	2,76	70,0	1,10	28,0
*0428601633	1"	25,4	16	1-11	0,79	20,0	1,50	38	3,31	84,0	1,38	35,0

* ON REQUEST / SU RICHIESTA

BSP COMPACT FEMALE 60° FLARE 90° ELBOW
FEMMINA COMPATTA 90° BSP SV.60°
044120

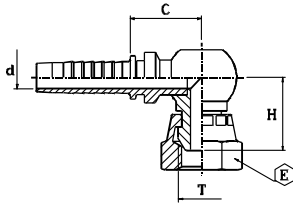

BSP COMPACT FEMALE 60° FLARE 90° ELBOW WITH THRUST WIRE NUT
FEMMINA COMPATTA 90° BSP SV.60° CON DADO SPINATO
044140

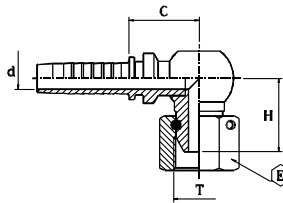

DKR-90-K

part nr. codice	hose ID			thread T	d		E		cut-off C		drop H	
	[in]	[mm]	size		[in]	[mm]	[in]	[mm]	[in]	[mm]	[in]	[mm]
0441200310	3/16"	4,8	03	1/8-28	0,12	3,0	0,55	14	0,59	15,0	0,67	17,0
0441200413	1/4"	6,4	04	1/4-19	0,16	4,0	0,75	19	0,99	25,0	0,83	21,0
0441200517	5/16"	8,0	05	3/8-19	0,22	5,5	0,87	22	1,02	26,0	0,87	22,0
0441200617	3/8"	9,5	06	3/8-19	0,28	7,0	0,87	22	1,02	26,0	0,87	22,0
0441200621	3/8"	9,5	06	1/2-14	0,28	7,0	1,06	27	1,02	26,0	1,02	26,0
0441200821	1/2"	12,7	08	1/2-14	0,37	9,5	1,06	27	1,06	27,0	1,06	27,0
0441201023	5/8"	16,0	10	5/8-14	0,47	12,0	1,18	30	1,06	27,0	1,14	29,0
0441201227	3/4"	19,0	12	3/4-14	0,59	15,0	1,26	32	1,22	31,0	1,14	29,0
0441201633	1"	25,4	16	1-11	0,79	20,0	1,50	38	1,46	37,0	1,38	35,0
0441402042	1.1/4"	31,8	20	1.1/4-11	1,02	26,0	1,97	50	1,85	47,0	1,97	50,0

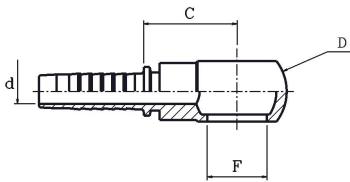

BSP BANJO

OCCHIO A PRESSARE BSP

RNR

part nr. codice	hose ID			F			D		d		cut-off C	
	[in]	[mm]	size	[in]	[mm]	size	[in]	[mm]	[in]	[mm]	[in]	[mm]
0450000310	3/16"	4,8	03	0,40	10,1	1/8	0,67	17,0	0,12	3,0	0,75	19,0
0450000313	3/16"	4,8	03	0,52	13,3	1/4	0,95	24,0	0,12	3,0	1,02	26,0
0450000410	1/4"	6,4	04	0,40	10,1	1/8	0,67	17,0	0,16	4,0	0,99	25,0
0450000413	1/4"	6,4	04	0,52	13,3	1/4	0,95	24,0	0,16	4,0	1,02	26,0
0450000417	1/4"	6,4	04	0,66	16,8	3/8	1,10	28,0	0,16	4,0	1,02	26,0
0450000513	5/16"	8,0	05	0,52	13,3	1/4	0,95	24,0	0,22	5,5	1,02	26,0
0450000517	5/16"	8,0	05	0,66	16,8	3/8	1,10	28,0	0,22	5,5	1,02	26,0
0450000613	3/8"	9,5	06	0,52	13,3	1/4	0,95	24,0	0,28	7,0	1,14	29,0
0450000617	3/8"	9,5	06	0,66	16,8	3/8	1,10	28,0	0,28	7,0	1,02	26,0
0450000621	3/8"	9,5	06	0,83	21,1	1/2	1,42	36,0	0,28	7,0	1,22	31,0
0450000817	1/2"	12,7	08	0,66	16,8	3/8	1,10	28,0	0,39	10,0	1,06	27,0
0450000821	1/2"	12,7	08	0,83	21,1	1/2	1,42	36,0	0,39	10,0	1,22	31,0
0450000827	1/2"	12,7	08	1,05	26,6	3/4	1,77	45,0	0,39	10,0	1,50	38,0
0450001023	5/8"	16,0	10	0,91	23,1	5/8	1,58	40,0	0,47	12,0	1,50	38,0
0450001227	3/4"	19,0	12	1,05	26,6	3/4	1,77	45,0	0,59	15,0	1,50	38,0
0450001233	3/4"	19,0	12	1,32	33,5	1	2,29	58,0	0,59	15,0	1,97	50,0
0450001633	1"	25,4	16	1,32	33,5	1	2,29	58,0	0,79	20,0	2,01	51,0

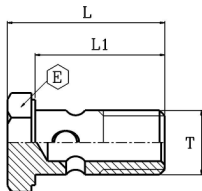

BSP BOLT

BULLONE FORATO BSP

BFG

part nr. codice	T	L		L1		E		Press. Max	
		[in]	[mm]	[in]	[mm]	[in]	[mm]	[psi]	[bar]
1555010000	1/8-28	0,95	24,0	0,77	19,5	0,55	14,0	4351	300
1555013312	1/4-19	1,36	34,5	1,12	28,5	0,75	19,0	4351	300
1555017400	3/8-19	1,60	40,5	1,30	33,0	0,87	22,0	4351	300
1555021460	1/2-14	1,81	46,0	1,50	38,0	1,06	27,0	3626	250
1555023500	5/8-14	1,97	50,0	1,65	42,0	1,18	30,0	2901	200
1555027690	3/4-14	2,21	56,0	1,85	47,0	1,26	32,0	2901	200
1555033860	1-11	2,72	69,0	2,29	58,0	1,62	41,0	2175	150

Two copper washers for bolt must be ordered separately
 Le due rondelle di rame per bullone devono essere ordinate separatamente.